

A1 ENTRY
ELEVATION - TYPE A1
SCALE 3/8" = 1'-0"

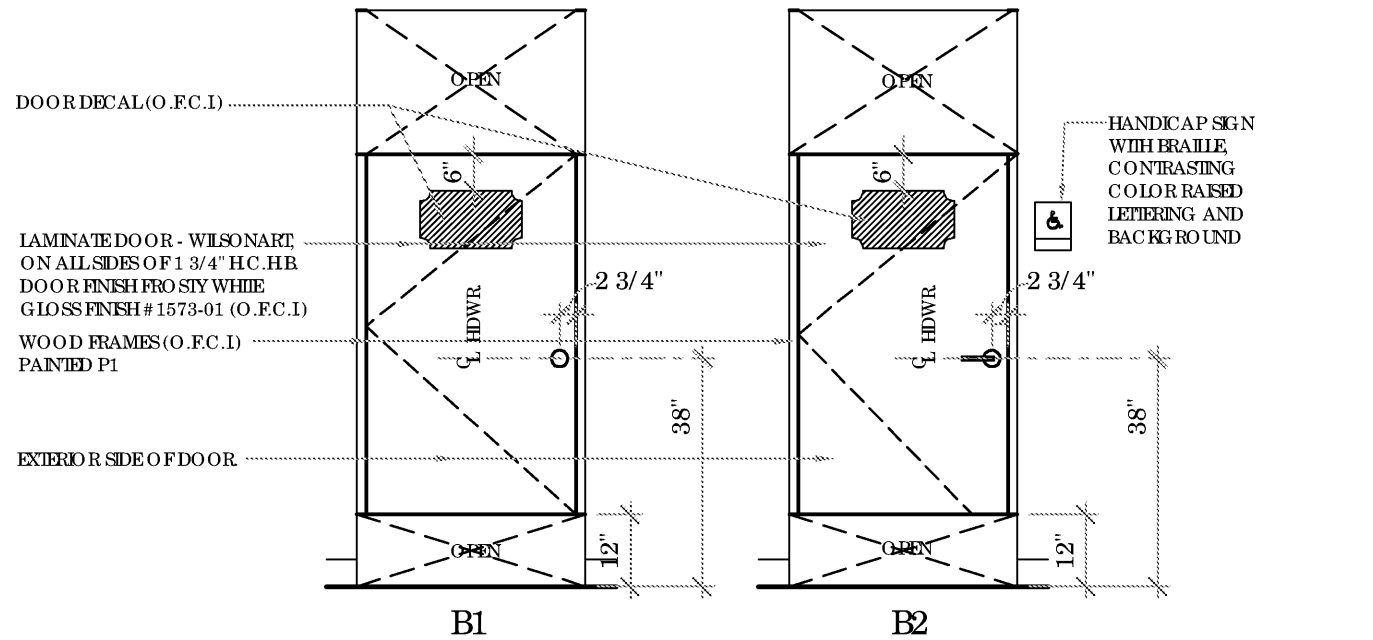

B FITTING ROOM & HC FITTING ROOM
ELEVATION - TYPE B1 & TYPE B2
SCALE 3/8" = 1'-0"

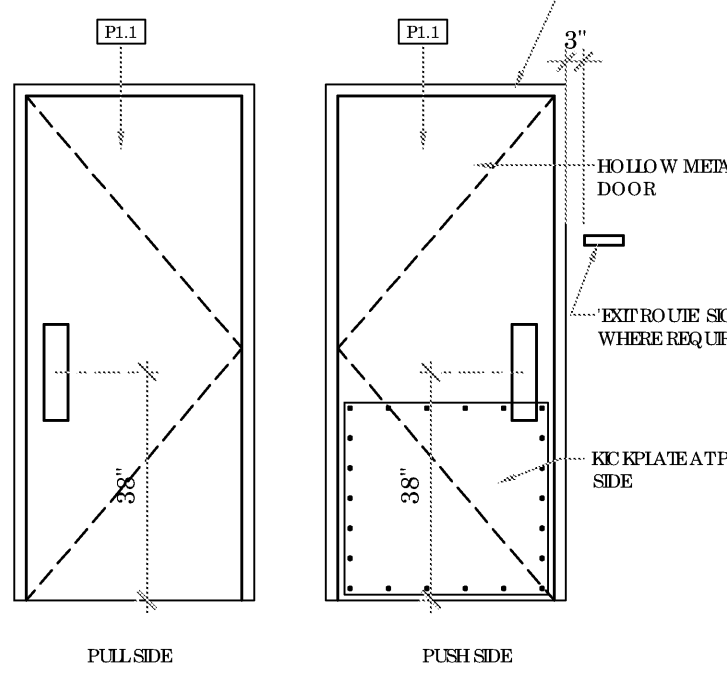

C1 SALES TO HALLWAY
ELEVATION - TYPE C1
SCALE 3/8" = 1'-0"

DOOR SCHEDULE										
NO.	DESCRIPTION	WIDTH	HEIGHT	THICKNESS	TYPE	HARDWARE GROUP	THRESHOLD	DOOR JAMB	DOOR HEAD	COMMENTS
1	ENTRY	12'-2"	10'-1"	--	A1	A1	3/A.0	1/A.3.2	6/A.3.2	--
2	FITTING ROOM	2'-11 1/4"	5'-0"	1 3/4" H.C.H.R.	B1	B1	N/A	9/A.0.0	N/A	--
3	HC FITTING ROOM	2'-11 1/4"	5'-0"	1 3/4" H.C.H.R.	B2	B2	N/A	9/A.0.0	N/A	--
4	SALES AREA TO HALLWAY	3'-0"	7'-0"	1 3/4"	C1	C1	4/A.0.0	1/A.0.0	2/A.0.0	--
5	HALLWAY TO STOCK ROOM	3'-0"	7'-0"	1 3/4"	C2	C2	N/A	1/A.0.0	2/A.0.0	--
6	RESTROOM	3'-0"	7'-0"	1 3/4"	D1	D1	8/A.0.0	1/A.0.0	2/A.0.0	--
7	SERVICE EXIT	3'-0"	7'-0"	1 3/4"	E1	E1	6/A.0.0	1/A.0.0	2/A.0.0	60 MIN.

HARDWARE SCHEDULE			
QTY.	HARDWARE	FINISH	PRODUCT SPECIFICATION

GROUP A1 - ENTRY			
ALL DOOR HARDWARE PROVIDED BY MANUFACTURER EXCEPT CORE			
BEST CORE 7 PIN SYSTEM			
CONSTRUCTION CORE W/ CONTROL KEY AND KEYS BY MANUFACTURER			

GROUP B1 - FITTING ROOM			
(1) SPRING HINGE MODEL 1250, SIZE 4" X 4"; BOTTOM HINGE	US2D	HAGER	
(1) BUTT HINGE MODEL BB191, SIZE 4" X 4"; TOP HINGE	US2D	HAGER	
WALL BUMPER MODEL WS402CVX, MOUNT ON DOOR FACE - SEE SHEET A4.2 FOR MOUNTING LOCATION	US2D	NVS	
PRIVACY SEAL MODEL A405 PLY 11-116 10-025; NO SHRE BOX	US2D	SCHLAGE	

GROUP B2 - HC FITTING ROOM			
(1) SPRING HINGE MODEL 1250, SIZE 4" X 4"; BOTTOM HINGE	US2D	HAGER	
(1) BUTT HINGE MODEL BB191, SIZE 4" X 4"; TOP HINGE	US2D	HAGER	
WALL BUMPER MODEL WS402CVX, MOUNT ON DOOR FACE - SEE SHEET A4.2 FOR MOUNTING LOCATION	US2D	NVS	
DOOR LEVER MODEL A405 NRP 11-116 10-025; NO SHRE BOX	US2D	SCHLAGE	

GROUP C1 - SALES TO HALLWAY			
(3) FULL MOIST HINGE MODEL BB279, SIZE 4 1/2" X 4 1/2"	US2D	HAGER	
PUSH/PULL PLATE MODEL 1895-3, SIZE 3 1/2" X 15"	US2D	TRMCO	
WALL BUMPER MODEL WS402CVX	US2D	NVS	
CLOSER MODEL 1461-R SERIES, MOUNT ON PULL SIDE, TOP JAMB MOUNT	US2D	LCN	
FLOOR STOP MODEL FS13	US2D	NVS	
ARMOR PLATE MODEL KA050-2, SIZE 34" W, 30" HIGH, SCREW MOUNT, MOUNT ON EACH SIDE OF DOOR	US2D	TRMCO	
DOOR SILENCER MODEL 307D	GREY	HAGER	

GROUP C2 - HALLWAY TO STOCK			
(3) FULL MOIST HINGE MODEL BB279, SIZE 4 1/2" X 4 1/2"	US2D	HAGER	
PUSH/PULL PLATE MODEL 1895-3, SIZE 3 1/2" X 15"	US2D	TRMCO	
WALL BUMPER MODEL WS402CVX	US2D	NVS	
CLOSER MODEL 1461-R SERIES, MOUNT ON PULL SIDE, TOP JAMB MOUNT	US2D	LCN	
FLOOR STOP MODEL FS13	US2D	NVS	
ARMOR PLATE MODEL KA050-2, SIZE 34" W, 30" HIGH, SCREW MOUNT, MOUNT ON EACH SIDE OF DOOR	US2D	TRMCO	
DOOR SILENCER MODEL 307D	GREY	HAGER	

GROUP D1 - RESTROOM			
(3) FULL MOIST HINGE MODEL BB279, SIZE 4 1/2" X 4 1/2"	US2D	HAGER	
DOOR LEVER MODEL A405 NRP 11-116 10-025; NO SHRE BOX	US2D	SCHLAGE	
WALL BUMPER MODEL WS402CVX	US2D	NVS	
CLOSER MODEL 1461-R SERIES, MOUNT ON PULL SIDE, TOP JAMB MOUNT	US2D	LCN	
FLOOR STOP MODEL FS13	US2D	NVS	
ARMOR PLATE MODEL KA050-2, SIZE 34" W, 30" HIGH, SCREW MOUNT, MOUNT ON EACH SIDE OF DOOR	US2D	TRMCO	
DOOR SILENCER MODEL 307D	GREY	HAGER	

GROUP E1 - SERVICE EXIT			
NON-HANDLED RM EXIT DEVICE MODEL F198D-22DS, LENGTH SHORT (36") W/ ROLLER SHROUD, MODEL R870	US2D	FALCON	
EXIT ALARM MODEL EAX-500AC7 (INTERCHANGEABLE MOISTURE CYLINDER INSTALLED) W/ RELIABLE COILAR EXISTING N. DOOR MOUNTED	G.Y. GREY	DEMIX	
DOOR SWEEP MODEL 315CN	CLEAR ANOD.	PERMD	
CLOSER MODEL 1461-R SERIES, MOUNT ON TENANT SIDE	US2D	LCN	

ARMOR PLATE MODEL KA050-2, SIZE 34" W, 30" HIGH, SCREW MOUNT, MOUNT ON TENANT SIDE	US2D	TRMCO	
DOOR VIEWER MODEL 976U	US2D	TRMCO	
PRIMER GASKET MODEL 888W	BLACK/ MILL ALUM.	PERMD	
THRESHOLD MODEL 166SA	MILL ALUM.	PERMD	
(3) FULL MOIST HINGE MODEL BB191NRP (NON-REMOVABLE PIN), SIZE 4 1/2" X 4 1/2"	US2D	HAGER	
(3) DOOR SILENCER MODEL 307D	GREY	HAGER	
WALL BUMPER MODEL WS402CVX	US2D	NVS	

ADA NOTES
A. REFER TO ADA CLEARANCE REQUIREMENTS BELOW FOR CODE COMPLIANCE

DOOR NOTES	GENERAL HARDWARE NOTES
1. ALL DOORS SHALL BE 1 3/4" THICK UNLESS NOTED OTHERWISE.	AS APPLICABLE REQUIRED:
2. ALL DOORS SHALL BE TRIMMED AT THRESHOLD TO PROVIDE 3/4" MINIMUM CLEARANCE ABOVE FLOOR FINISH MATERIAL TO PERMIT FULL DOOR SWING, UNLESS NOTED OTHERWISE.	1. COORDINATE ALL KEYING WITH OWNER.
3. CONTRACTOR SHALL VERIFY ACTUAL DOOR HEIGHT REQUIRED FOR DOOR FRAME SYSTEM.	2. PROVIDE LEVER HARDWARE HANDLES ACCORDING TO SPEC ON SALES TO HALLWAY/STOCK AREA AND FITTING ROOMS.
4. ALL EXISTING DOORS, EXCLUDING REAR DOOR, TO HAVE SIGN WHICH READS "THIS DOOR TO REMAIN UNLOCKED WHEN BUILDING IS OCCUPIED."	3. PROVIDE PANIC HARDWARE W/ PUSH BAR ON REAR EXITS/SERVICE DOOR.
5. PROVIDE DOOR AND FRAME ASSEMBLY WITH APPROPRIATE LABELS FOR USE IN WALLS WITH REQUIRED FIRE RATING AS NOTED ON SCHEDULE.	4. PROVIDE A TIGHT FITTING SMOKE AND DRAFT CONTROL/SEAL ASSEMBLY RATED FOR 20 TO 60 MINUTES WHERE THE DOOR MEETS THE STOP AT JAMBS AND HEAD.
6. DIMENSIONS FOR UNDER DOORS IF ANY SHALL BE MEASURED FROM TOP OF FINISH FLOORING MATERIAL.	5. HARDWARE SHALL BE USED FOR USE ON PREXIS.
7. DOOR IN THE FULLY OPEN POSITION SHALL NOT REDUCE THE REQUIRED EXIT WIDTH BY MORE THAN 4 INCHES.	6. PROVIDE DOOR RINGING BELL/Buzzer, REFER TO ELECTRICAL DRAWINGS.
8. EXISTING ALWAYS SHALL BE NO LESS THAN 36" IN WIDTH AND NO LESS THAN 6'-8" IN HEIGHT. PROJECTIONS INCLUDING PANIC HARDWARE SHALL NOT REDUCE THE OPENING TO LESS THAN 32" CLEAR WIDTH.	7. PROVIDE SIGN ABOVE THE ENTRY DOOR THAT IS VISIBLE DURING BUSINESS HOURS "THIS DOOR TO REMAIN UNLOCKED AND OPEN DURING BUSINESS HOURS". SIGN S.C.F.C.1
9. LATCHING AND LOCKING DOORS THAT ARE HAND ACTIVATED AND WHICH ARE IN A PATH OF TRAVEL SHALL BE OPERABLE WITH A SINGLE PROXY BY LEVER TYPE HARDWARE, PANIC BARS, PUSH/PULL ACTIVATING BARS OR OTHER HARDWARE DESIGNED TO PROVIDE PASSAGE WITHOUT REQUIRING THE ABILITY TO GRASP THE OPENING HARDWARE. LOCKED EXITS DOORS SHALL OPERATE AS NOTED ABOVE IN THESE DIRECTIONS.	8. PLACE A SIGN ON THE HALLWAY/STOCK AREA DOOR NOT AN EXIT. SIGN S.C.F.C.1
10. HAND-ACTIVATED DOOR OPENING HARDWARE SHALL BE CENTERED BETWEEN 34" AND 48" ABOVE THE FLOOR.	9. PLACE A SIGN ON THE FITTING ROOM TO HALLWAY/STOCK AREA DOOR TEMPORARILY ONLY. SIGN S.C.F.C.1
11. THERE SHALL BE A LEVEL AND CLEAR FLOOR OR LANDING ON EACH SIDE OF A DOOR. THE LEVEL AREA SHALL HAVE A LENGTH IN THE DIRECTION OF DOOR SWING OF AT LEAST 60" AND THE LENGTH OF THE DIRECTION OF DOOR SWING OF 60" AS MEASURED AT RIGHT ANGLES TO THE PLANE OF THE DOOR IN THE CLOSED POSITION. THE FLOOR OR LANDING SHALL BE LESS THAN OR EQUAL TO 1/2" LOWER THAN THE THRESHOLD.	10. PLACE DOOR SIGNS FOR RESTROOMS REFER TO DETAILS A4.3, C.F.C.1
12. THE WIDTH OF THE LEVEL AREA ON THE SIDE TO WHICH THE DOOR SWINGS SHALL EXTEND A MINIMUM OF 18" PAST THE SILL EDGE FOR INTERIOR DOORS.	11. PROVIDE A SIGN ON THE BACK OF THE REAR EXITS/SERVICE DOOR, G.C. TO COORDINATE WITH LANDLORD. SIGN S.C.F.C.1
13. THE BOTTOM 16" OF ALL DOORS EXCEPT AUTOMATIC SLIDING SHALL HAVE A SMOOTH UNFINISHED SURFACE TO ALLOW THE DOOR TO BE OPENED BY A WHEEL CHAIR OR PERSON WITH UTICATING A TRAP OR HAZARDOUS CONDITION. WHEN NARROW FRAME DOORS ARE USED, A 10" HIGH SMOOTH PANEL SHALL BE INSTALLED ON THE PUSH SIDE OF THE DOOR, WHICH WILL ALLOW THE DOOR TO BE OPENED BY A WHEEL CHAIR OR PERSON WITH UTICATING A TRAP OR HAZARDOUS CONDITION.	12. CLOSER TO PROVIDE STOP FUNCTION AT 90° MIN. ON REAR EXITS DOOR.
14. MAXIMUM WEIGHT TO OPERATE DOORS SHALL NOT EXCEED 8.5 POUNDS FOR EXTERIOR DOORS AND 5 POUNDS FOR INTERIOR DOORS. SUCH FULL OR PUSH OR PULL BEING APPLIED AT RIGHT ANGLES TO HINGED DOORS AND AT THE CENTER PLANE OF SLIDING OR ROLLING DOORS. COMPENSATING DEVICES OR AUTOMATIC DOOR OPERATORS MAY BE INCREASED TO THE MAXIMUM ALLOWABLE BY THE APPROPRIATE ADMINISTRATIVE AUTHORITY, NOT TO EXCEED 15 POUNDS.	
15. ALL DOORS SHALL BE BEST 7-PIN, INTERCHANGEABLE COIL CYLINDERS.	
16. PROVIDE KEYS OF ALL KEYS TO OWNER.	
17. ALL METAL DOORS & FRAMES TO BE OIL-BASED SEMI-GLOSS P.L.	

1 TYPICAL DOOR JAMB
DETAIL
SCALE 3" = 1'-0"

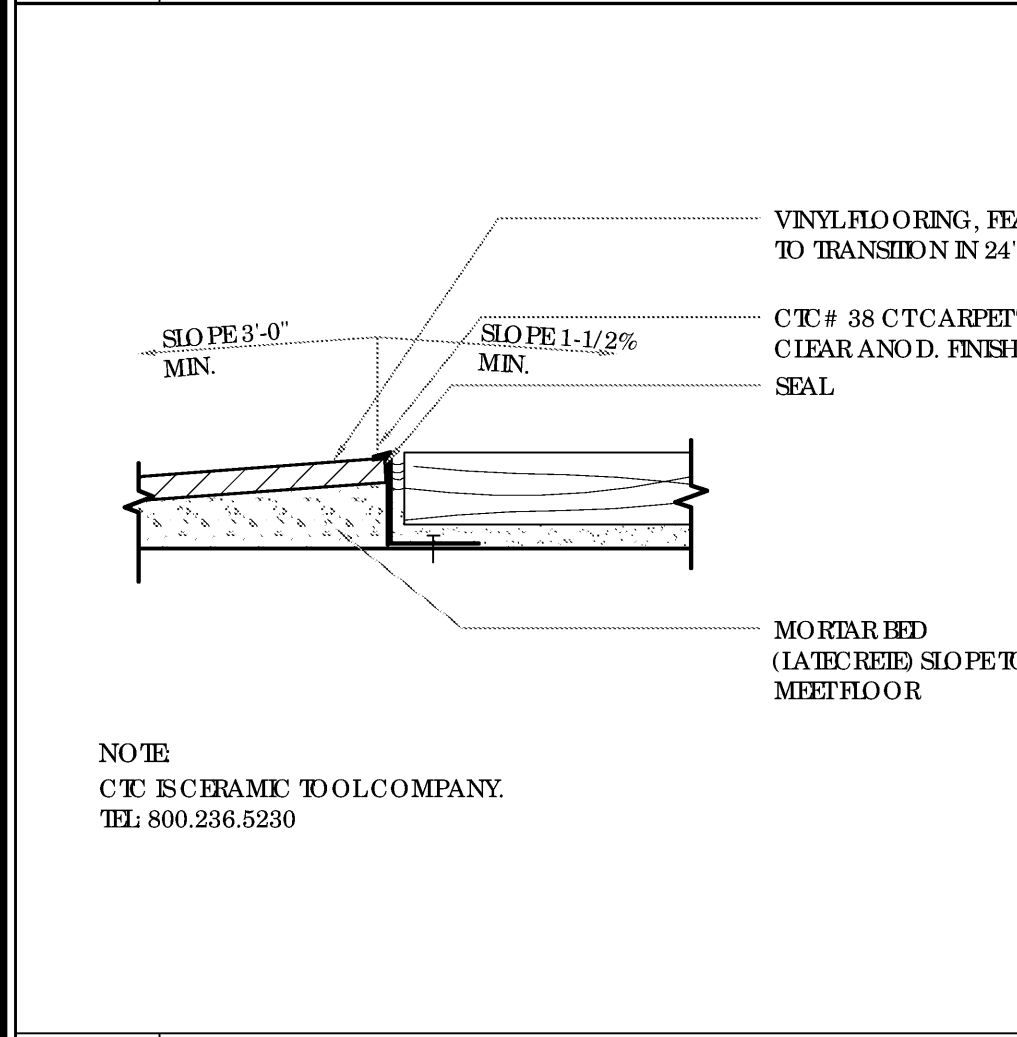

2 TYPICAL DOOR HEAD
DETAIL
SCALE 3" = 1'-0"

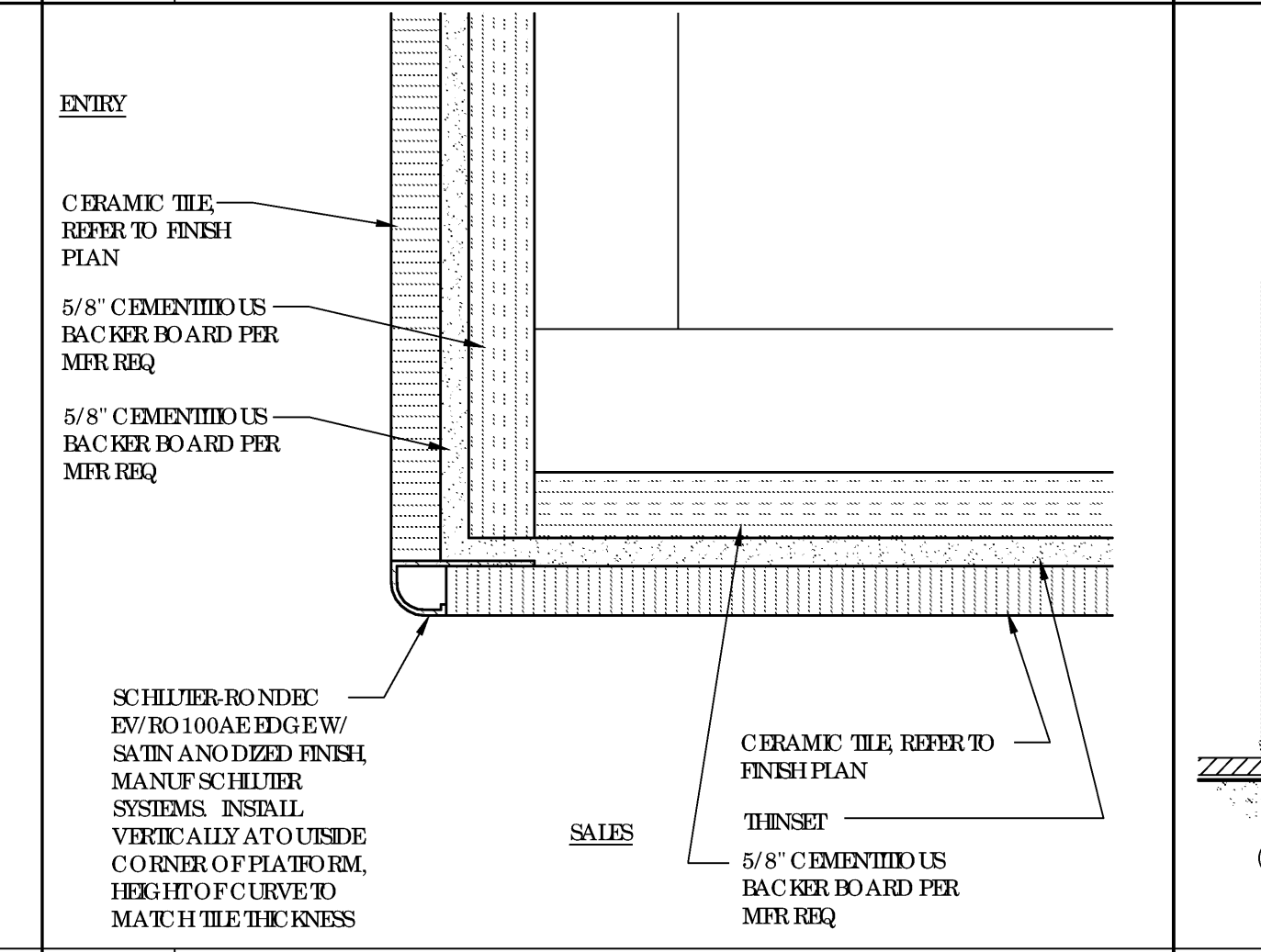

3 TILE TO TILE
DETAIL
SCALE 3" = 1'-0"

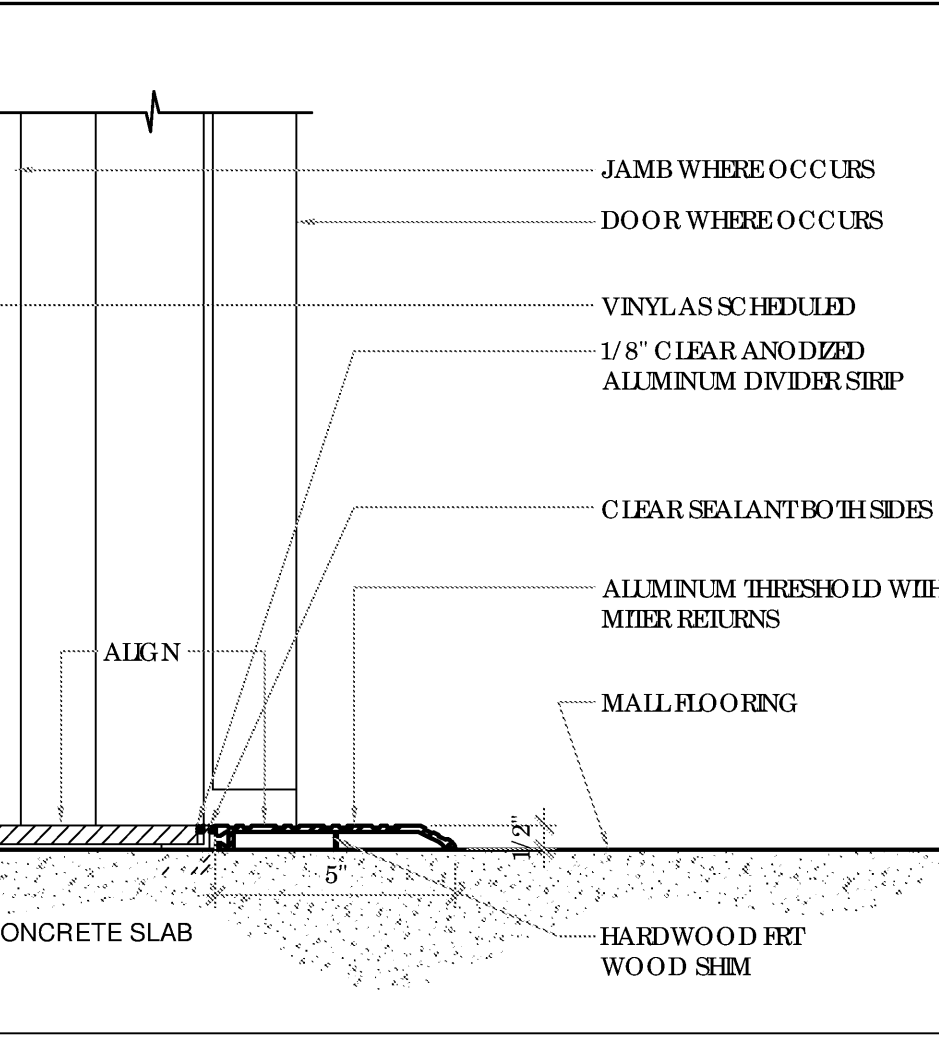

4 STONE TO VINYL
DETAIL
SCALE 1'-0" = 1'-0"

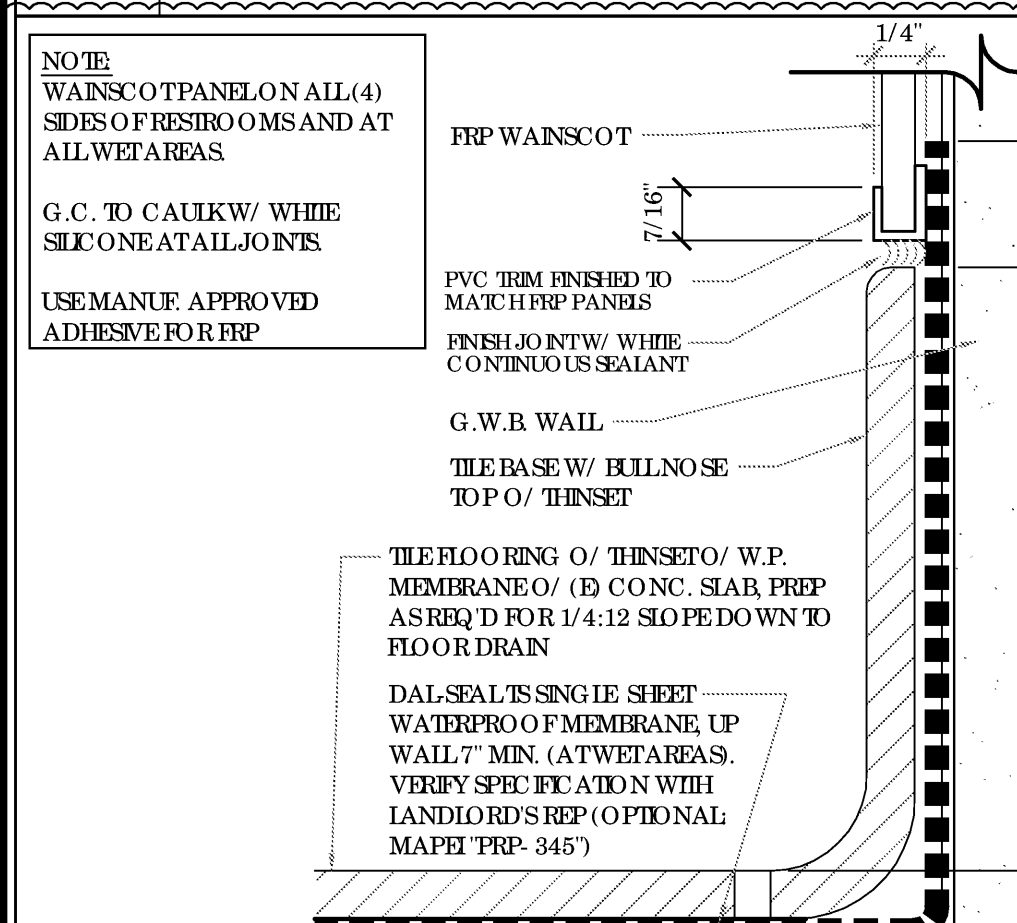

5 PLATFORM DETAIL
DETAIL
SCALE 3" = 1'-0"

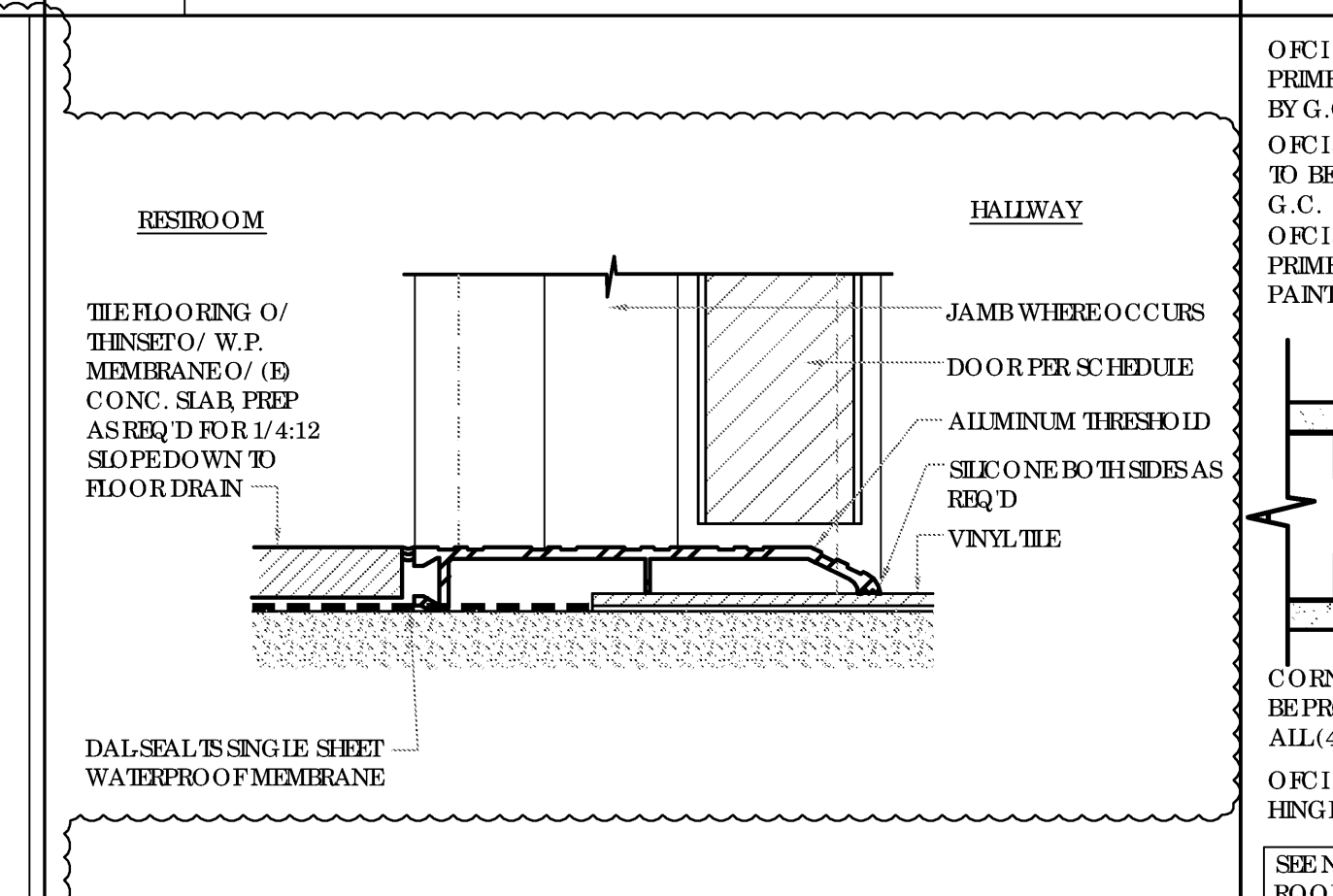

6 VINYL TO MAIL FLOORING
DETAIL
SCALE 3" = 1'-0"

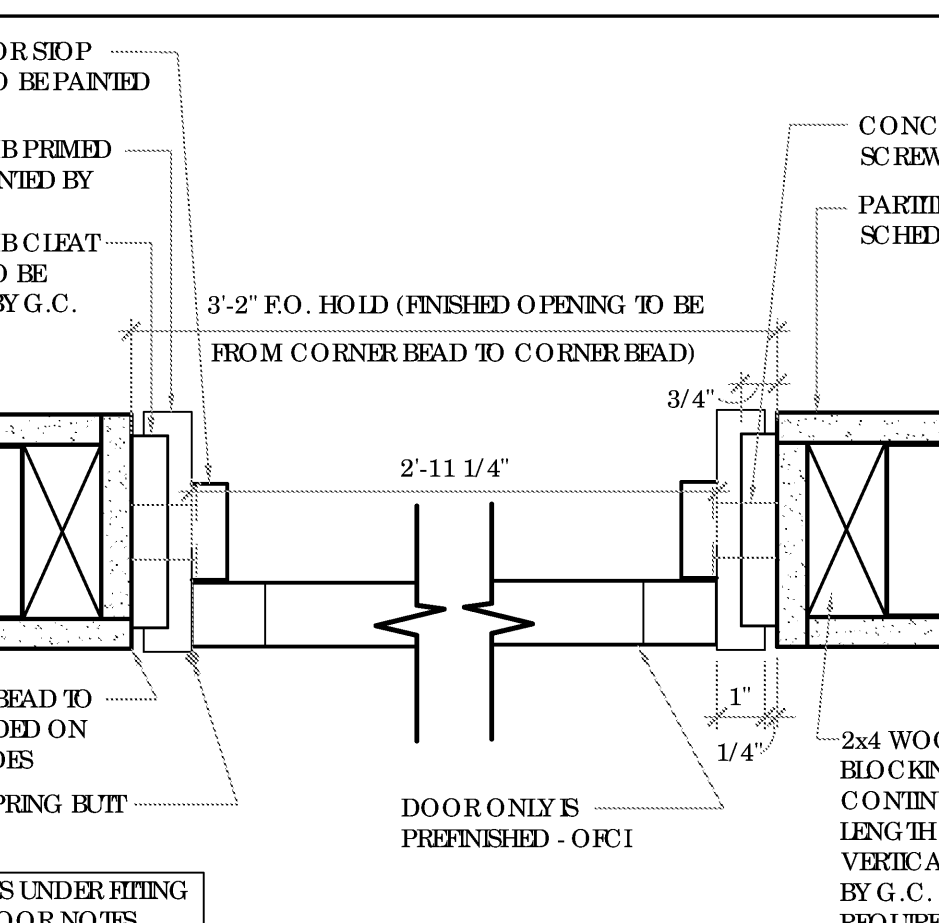

7 TILE BASE
DETAIL
SCALE 1'-0" = 1'-0"

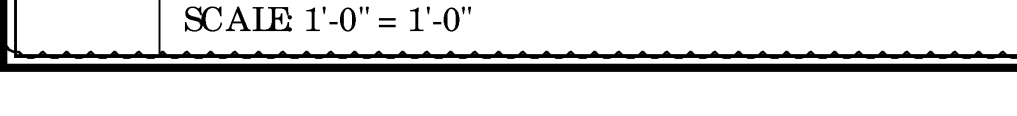

8 RESTROOM FLOOR
DETAIL
SCALE 3" = 1'-0"



9 TYP. FITTING ROOM JAMB
DETAIL
SCALE 3" = 1'-0"



FREDERICK J. GOGGIA
ARCHITECT, NO. AB, FDI
1850 GRAY ROAD, SUITE 300
ST. LOUIS, MO 63146
PH: (314) 415-2400 FAX: (314) 415-2300
www.fjg.com

charlotte russe

UNIVERSITY TOWN CENTER
140 UNIVERSITY TOWN CENTER DRIVE - SUITE #20
SAPASOTA, FL 34243
SPACE # 210 STORE # 786

REV	DATE	DESCRIPTION
1	07/28/14	ISSUE TO PERMIT
2	07/29/14	OWNER
3	10/06/14	ISSUE TO BID
4	10/06/14	ELITE CONSULTING GROUP
5	10/06/14	PHONE: 727-283-0072
6	10/06/14	EDUCATED BY: VICTORIA L. HARRIS
7	10/06/14	SCALE: 1/8" = 1'-0"
8	10/06/14	DATE: 07/28/14

A0.0